

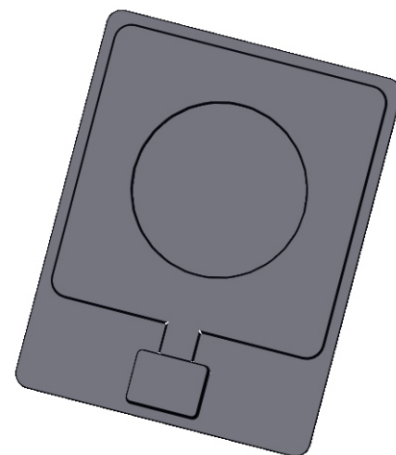

Antenna 300x300

Applications:

- ✓ Library Management
- ✓ Inventory
- ✓ Point of Sale



Technical Specifications

Part Number

ID-HF-AT-1E

| | |
|------------------------|---|
| Operating Frequency | 13.56 MHz |
| Impedance | 50 \pm 0.5 |
| Maximum RF input Power | 2 W |
| Read Range | 250 mm |
| Dimensions | 500 (L) x 390 (W) x 22 (D) all dimensions are in mm |
| Case Material | ABS, Black |
| Weight | 400 grams |
| Protection Class | IP 65 |
| Surface Finish | Matte Finish |
| Operating Temperature | -30 $^{\circ}$ C to +60 $^{\circ}$ C |
| Storage Temperature | -40 $^{\circ}$ C to +70 $^{\circ}$ C |
| Connection Terminals | SMA Male |